

SPECIALTY PLASTICS

PLUGS, CAPS, CLOSURES FOR THE ENGINEERING AND ALLIED TRADES

Unit 1, 14 Moriarty Road, Welshpool WA 6106
 Telephone: (08) 9353 5504 Fax: (08) 9353 5599
 email: sales@specialtyplastics.com.au

SNAP-FIT PLUGS

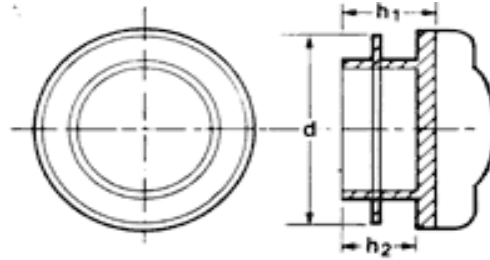

A quick-fitting alternative to the standard threaded plug, these snap-fit plugs will give a tight fit with only a single turn of the plug once it is pushed into position. The design also enables each plug to cover variety of threads.

Part Number	To Fit Thread			Standard Pack Size	Handy Pack Size	Mini Pack Size
	Metric	BSP/GAS	UNF/JIC			
12363	M12, M13, M14	1/4"	1/2"	10000	1000	100
12364	M16	3/8"	5/8"	10000	500	100
12365	M20	1/2"	-	5000	500	100
12367	M25, M26	3/4"	1 1/16"	2000	300	50
12368	M28	7/8"	1 1/8"	3000	300	50
12369	M32	1"	1 5/16"	2500	250	50

Other Sizes are Available

www.specialtyplastics.com.au