

SPECIALTY PLASTICS

PLUGS, CAPS, CLOSURES FOR THE ENGINEERING AND ALLIED TRADES

Unit 1, 14 Moriarty Road, Welshpool WA 6106
Telephone: (08) 9353 5504 Fax: (08) 9353 5599
email: sales@specialtyplastics.com.au

PIPE PROTECTION CAPS

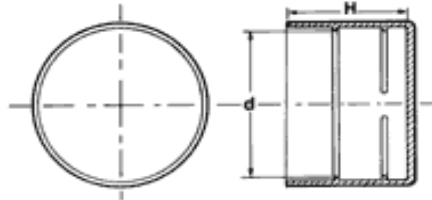

SPECIFICATIONS

Standard Material: Grade 1 Virgin Polyethylene

| Part Number | Nominal Bore Size | Length (mm) |
|-------------|-------------------|-------------|
| PC1 | 1"/25 NB | 21.46 |
| PC1 1/4 | 1/4"/32 NB | 37.21 |
| PC1 1/2 | 1/2"/40 NB | 37.21 |
| PC2 | 2"/50 NB | 37.21 |
| PC2 1/2 | 2 1/2"/65 NB | 37.21 |
| PC3 | 3"/80 NB | 37.21 |
| PC4 | 4"/100 NB | 43.05 |
| PC5 | 5" NB | 43.05 |
| PC6 | 6"/150 NB | 55.88 |
| PC8 | 8"/200 NB | 63.5 |
| PC10 | 10"/250 NB | 70.31 |
| PC12 | 12"/300 NB | 71.63 |
| PC14 | 14"/350 NB | 71.12 |
| PC16 | 16"/400 NB | 72.06 |
| PC18 | 18"/450 NB | 72.26 |
| PC20 | 20"/500 NB | 75.06 |
| PC24 | 24"/600 NB | 76.07 |
| PC30 | 30"/750 NB | 75.95 |

www.specialtyplastics.com.au