

SPECIALTY PLASTICS

PLUGS, CAPS, CLOSURES FOR THE ENGINEERING AND ALLIED TRADES

Unit 1, 14 Moriarty Road, Welshpool WA 6106
Telephone: (08) 9353 5504 Fax: (08) 9353 5599
email: sales@specialtyplastics.com.au

FLANGE CAPS AND WASHERS FLANGED WASHERS W Series

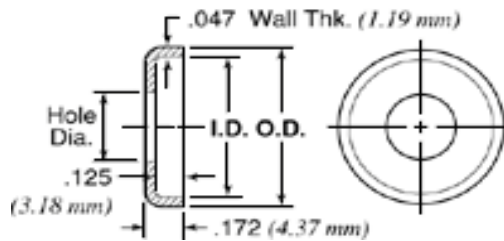

The W Series Flanged Washer is typically applied as a tube end cover.

SPECIFICATIONS

Standard Colour: Yellow

Standard Material: Grade 1 Virgin Polyethylene

Part Number	Dimensions			Standard Pack Size	Handy Pack Size
	Hole Diameter (mm)	I.D. (mm)	O.D. (mm)		
W-6	8.13	14.96	17.40	19000	500
W-8	11.30	19.30	21.84	12000	500
W-10	14.61	22.10	24.59	10000	500
W-13	17.78	26.42	28.98	7000	300
W-15	21.03	29.59	32.16	5000	300

www.specialtyplastics.com.au