

# SPECIALTY PLASTICS

PLUGS, CAPS, CLOSURES FOR THE ENGINEERING AND ALLIED TRADES

Unit 1, 14 Moriarty Road, Welshpool WA 6106  
 Telephone: (08) 9353 5504 Fax: (08) 9353 5599  
 email: sales@specialtyplastics.com.au

## FLANGE CAPS AND WASHERS S.A.E.

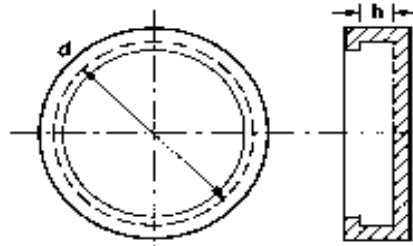

### SPECIFICATIONS

Standard Colour: Red

Part Number	RYCO Part Numbers	Size	Dimensions			Standard Pack Size	Handy Pack Size
			Normal Dia.	Flange Dia.	Flange Depth		
			In.	mm (d)	mm (h)		
<b>SAE 3000PSI</b>							
12005	FC61-12	CODE 61 - 3/4"	3/4"	37	9	1000	100
12006	FC61-16	CODE 61 - 1"	1"	44	10	1000	100
12007	FC61-20	CODE 61 - 1 1/4"	1 1/4"	50	10	1000	80
12008	FC61-24	CODE 61 - 1 1/2"	1 1/2"	60	10	1000	80
12009	FC61-32	CODE 61 - 2"	2"	70	11	1000	50
<b>SAE 6000PSI</b>							
12534	FC62-08	CODE 62 - 1/2"	1/2"	31.8	7.7	1000	100
12535	FC62-12	CODE 62 - 3/4"	3/4"	41.3	8.7	1000	100
12536	FC62-16	CODE 62 - 1"	1"	47.6	9.5	1000	100
12537	FC62-20	CODE 62 - 1 1/4"	1 1/4"	54	10.3	1000	50
12538	FC62-24	CODE 62 - 1 1/2"	1 1/2"	63.5	12.6	1000	50
12539	FC62-32	CODE 62 - 2"	2"	79.4	12.6	1000	50

Also available in natural colour - see Q Series

[www.specialtyplastics.com.au](http://www.specialtyplastics.com.au)